



GREENSPARK



MODULAR HOUSING
268 LORD STREET PERTH



MODULAR HOUSING VISUALISATION

DESIGN APPROACH

Guiding Principles



COMPACT LIVING



TECHNOLOGY



LUXURY



AFFORDABILITY

KEY
Designs



FLOOR PLAN

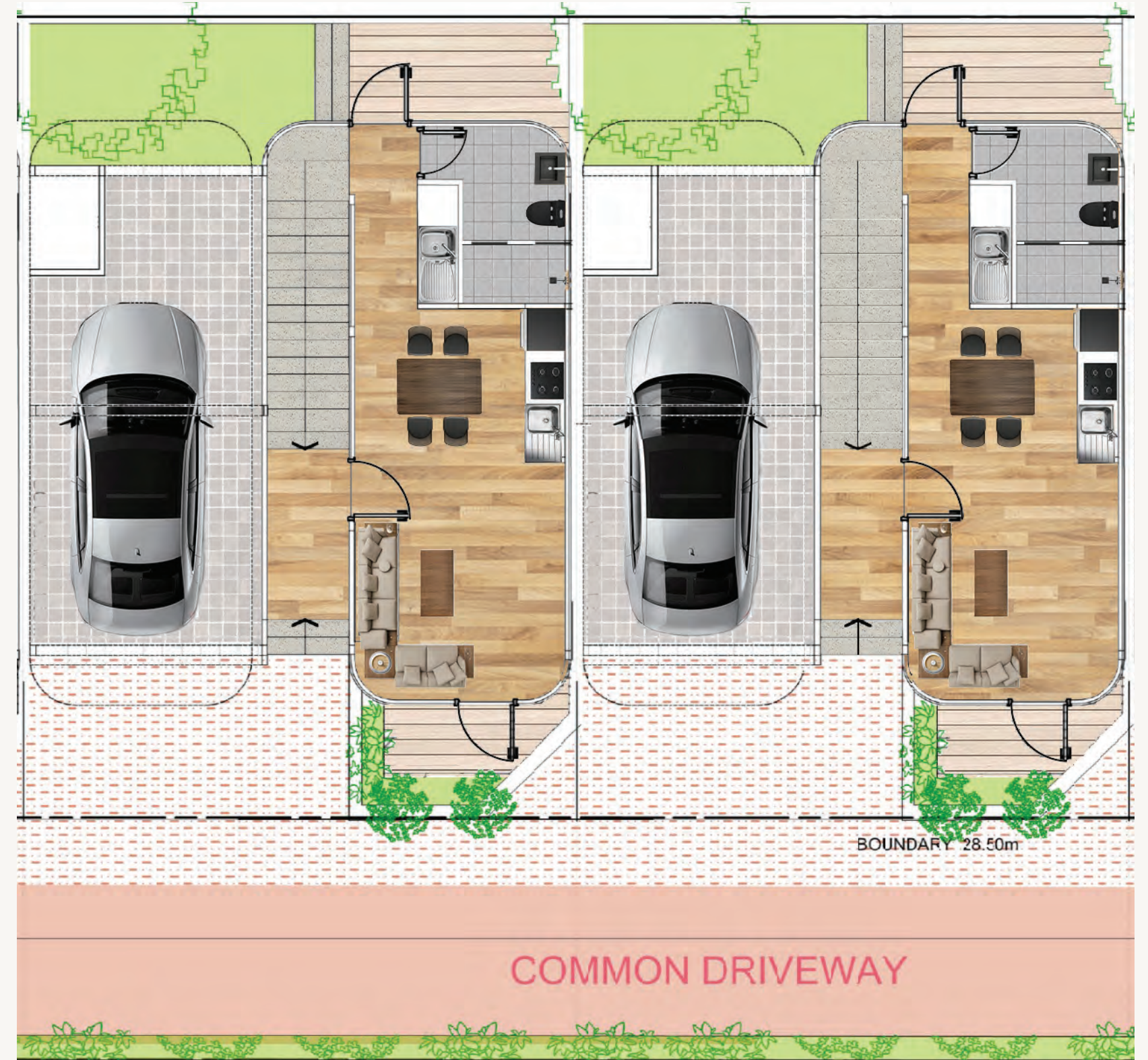

SITE PLAN

CONCEPTS



TERRACED LANDSCAPED
ENTRY POINT AND ENTRY HOOD



THE URBANIST



THE MARINER

THE *Urbanist*



MASTER BEDROOM WITH STUDY



COMPACT DINING AND KITCHEN

MODULAR HOME

FLOOR PLAN



1 Bedrooms



1 Bathroom



38m2 area

CONCEPT *Variations*



MODULAR HOTEL SUITE



2 Bedrooms



1 Bathroom



38m² area

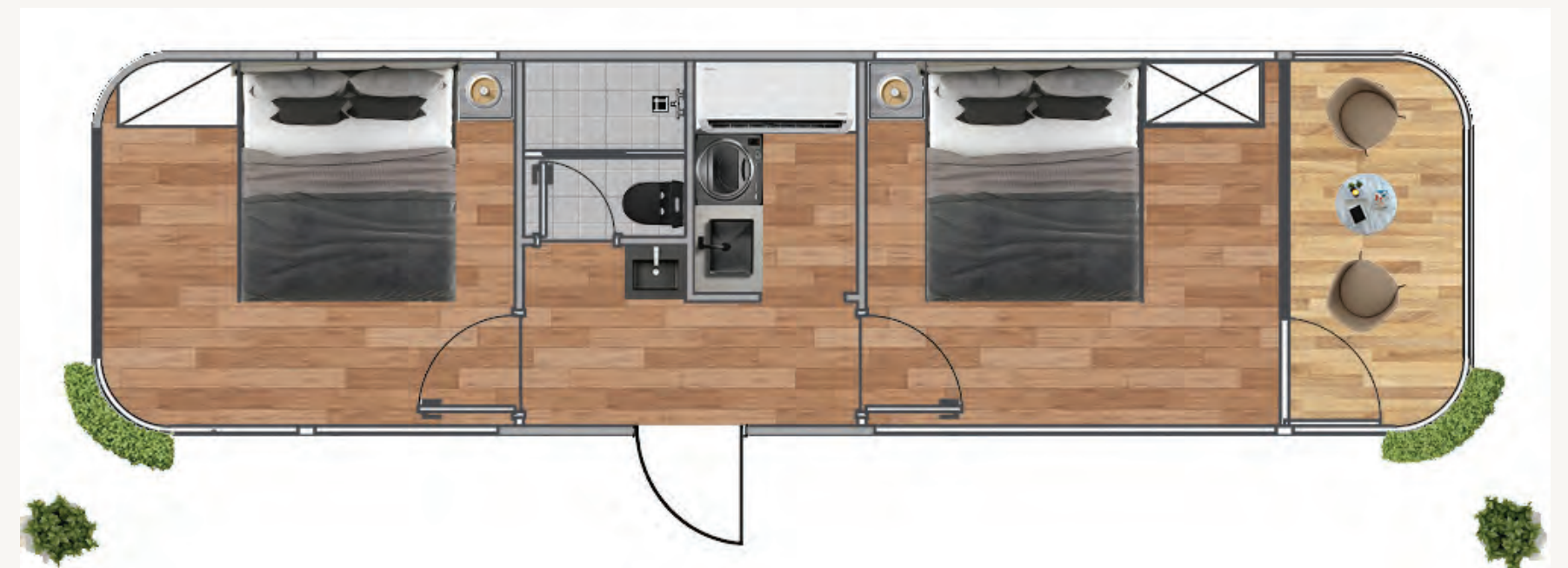

FLOOR PLAN



DUO DWELLING



FLOOR PLAN



70m2 area



2/3 Bedrooms



2 Bathrooms

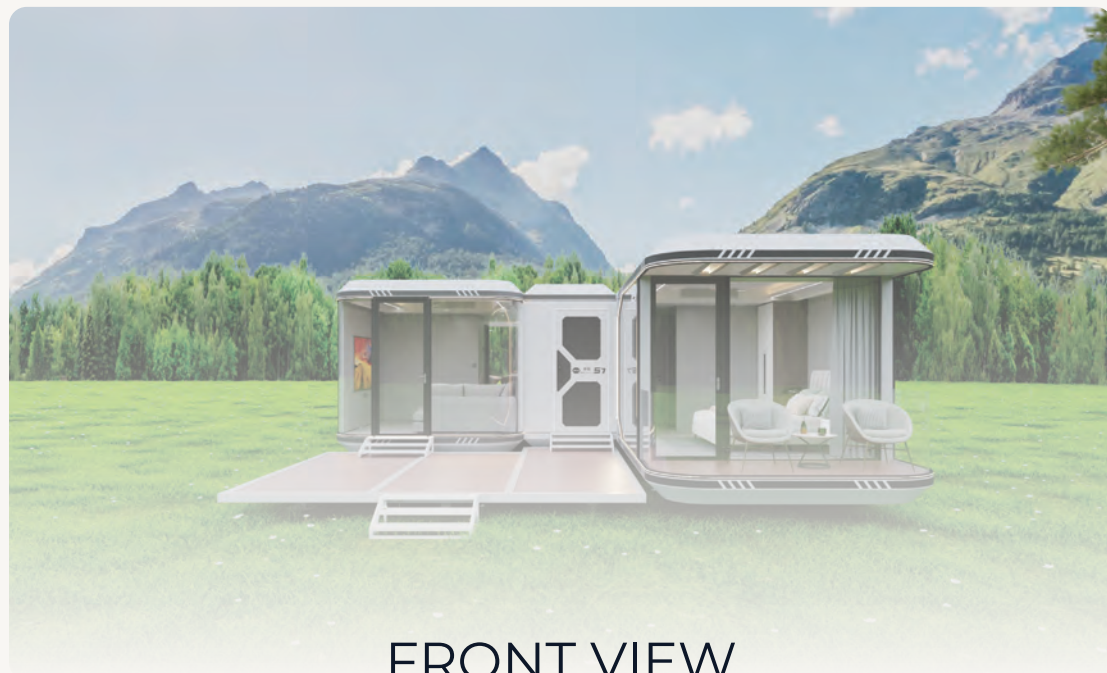

FRONT VIEW



TOP VIEW - 1



TOP VIEW - 2

SKYHAUS Rooftop Retreat



2/3 Bedrooms



2 Bathroom



76m2 area



Roof Deck

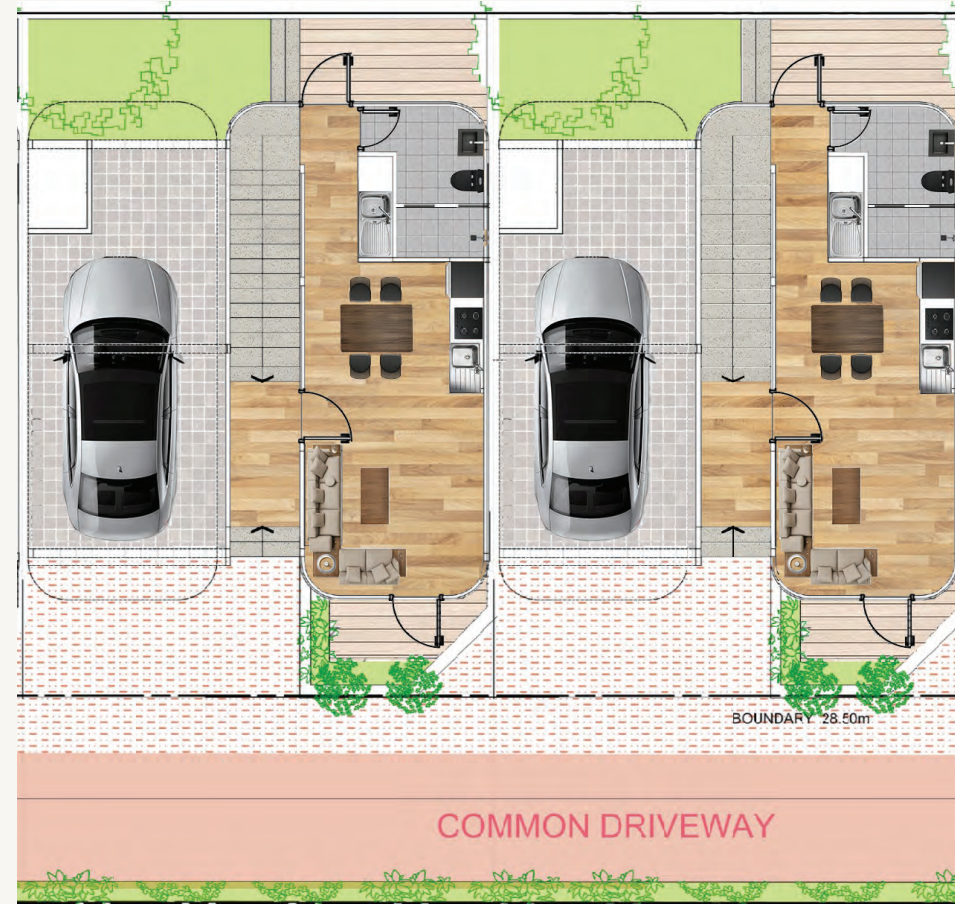

SITE PLAN



FIRST FLOOR PLAN



SKYHAUS - TWO STOREY WITH ELEVATED ROOF RETREAT

CONFIGURATION *List*

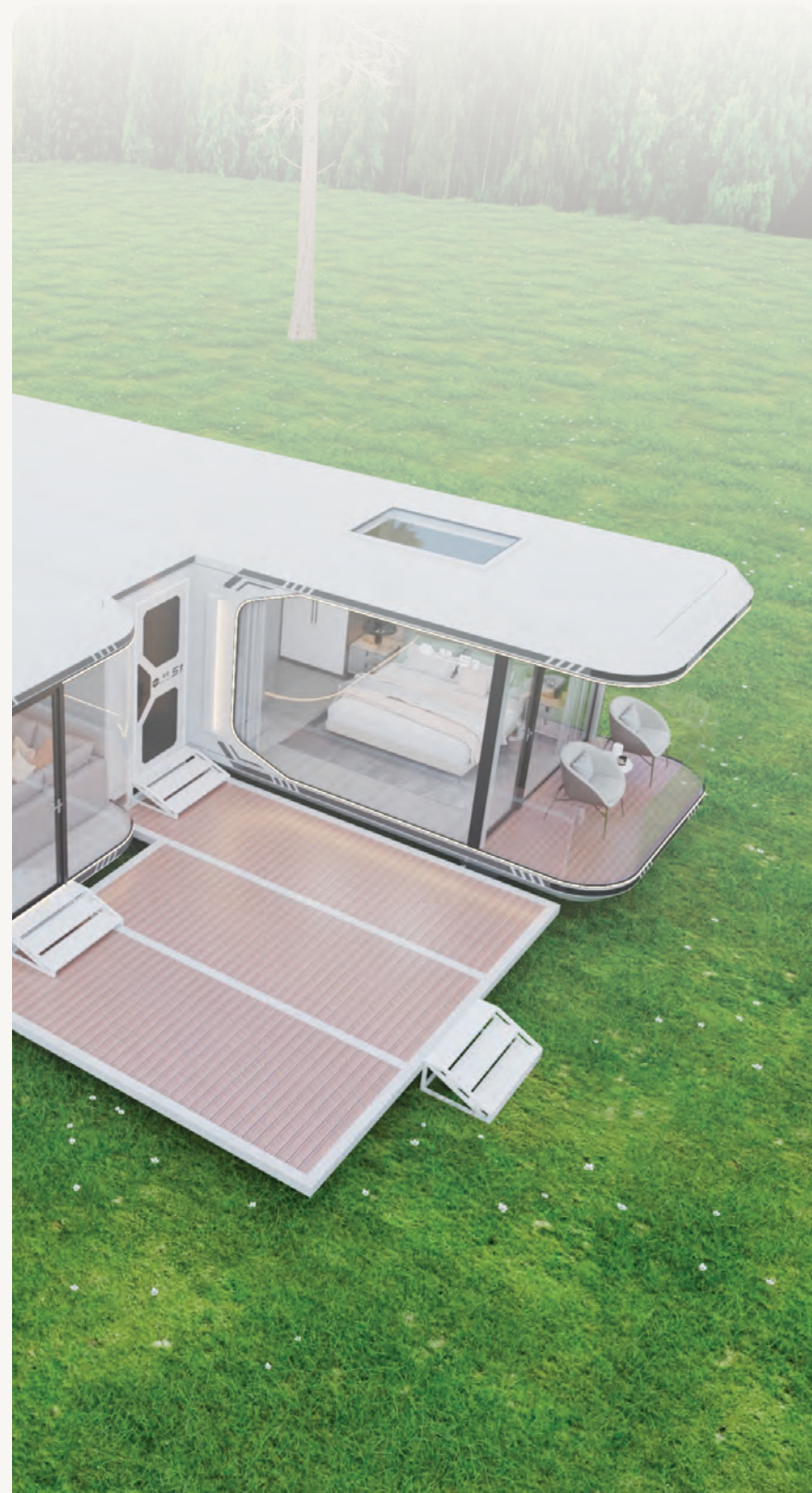

STRUCTURAL FEATURES

Galvanized steel structural frame system

Powdercoated aluminium facade and cladding

Thermal insulation, waterproof, and moisture proof construction system

Doubled glazed tempered glass doors and windows

Hollow laminated tempered glass skylight

Stainless steel entrance door

Panoramic balcony consistent returns without stress.



CONTROL SYSTEM

Insertion power card

Multi scene mode function panel lighting

Intelligent integrated control of lighting/curtains

Intelligent voice control throughout the house

Mobile smart access control

AS compliant wiring and safety.



INTERIOR DESIGN

Standard color integrated ceiling and wall modules

Environmentally friendly composite flooring

Carbon crystal plate interior wall panels

Auto skylight.to living

Bathroom privacy glass door

Automatic flushing Toilet.

Customized sink/basin

Illuminated bathroom mirror

Whole house lighting system

Whole house water and electricity system

2P Midea variable frequency heating and cooling air conditioning

A selection of standard interior colours and finishes to choose from

Fire resistant wall panels

Projection screen and sound system

Illuminated facade for surveillance



OPERATIONAL ITEMS

Double layer insulation structure of the wall

Electric auxiliary heating and underfloor heating

PV cells with backup battery optional extra.